

Installation Notes:
- Adjust Shelving is made for indoor use only.

- Mounting to a stud whenever possible is the best way to secure Adjust Shelving to the wall.

- If supporting Adjust Shelving on to the wall without a stud then the following apply:
* The wall board must be in good condition without water damage, or cracking.
* At least 1/2" drywall is required
* Shiplap or paneled walls must be at least 3/8" thick

- A single rail can support 35lbs. If more than 35lbs is on a single rail consider using the "Foot Kit".

What's Included

If any item is lost or damaged it can purchased at adjustshelving.com.

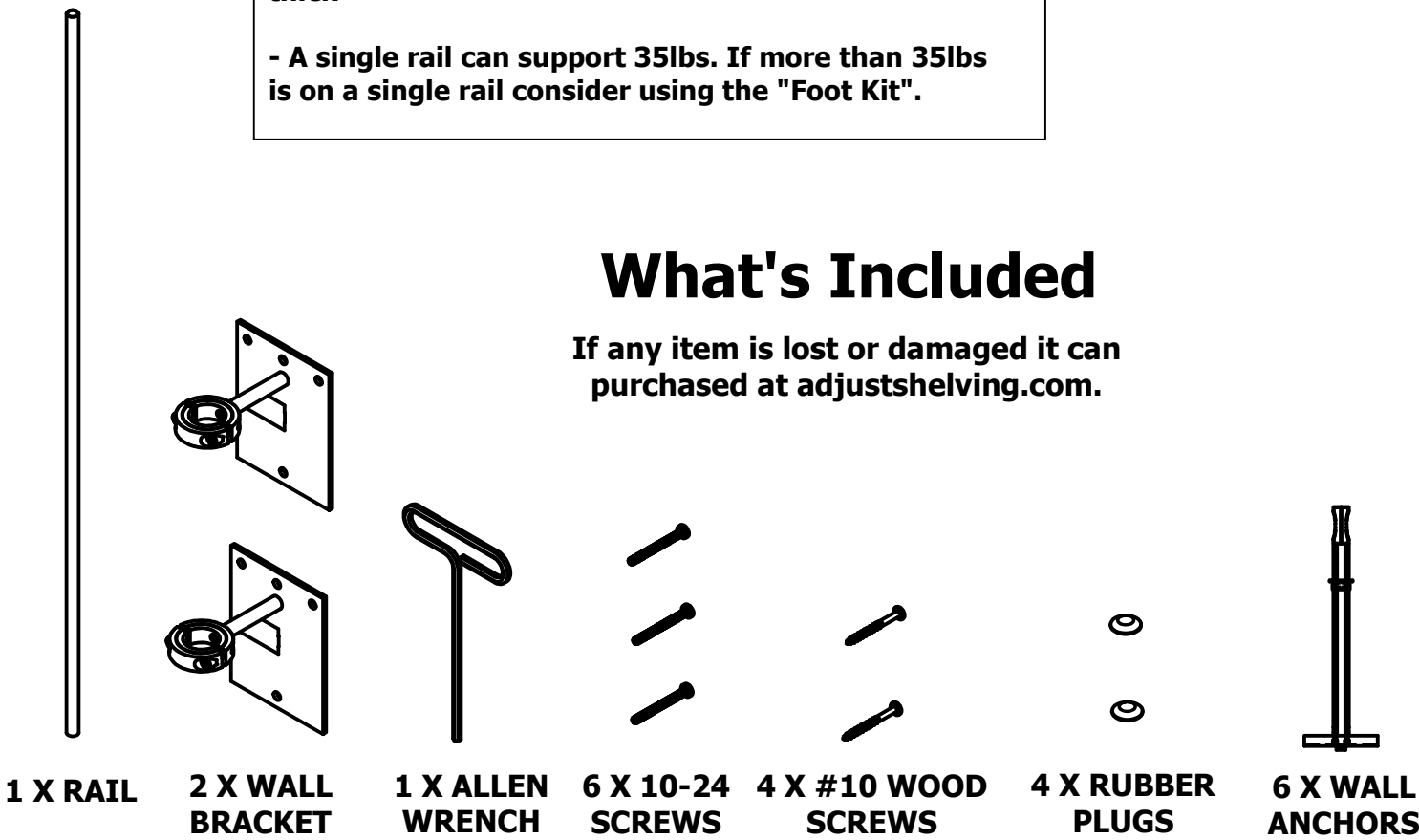

What's Needed

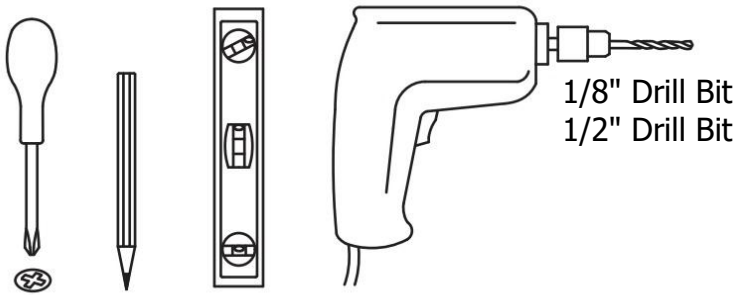

ATTENTION!
The assembly should be carried out by a qualified person. Improper installation could lead to the furniture/object toppling or falling resulting in personal injury or damage. Need help installing? www.thumbtack.com

Need Help Installing
www.thumbtack.com



Video - "install Adjust Shelving in a corner"



Adjustshelving.com

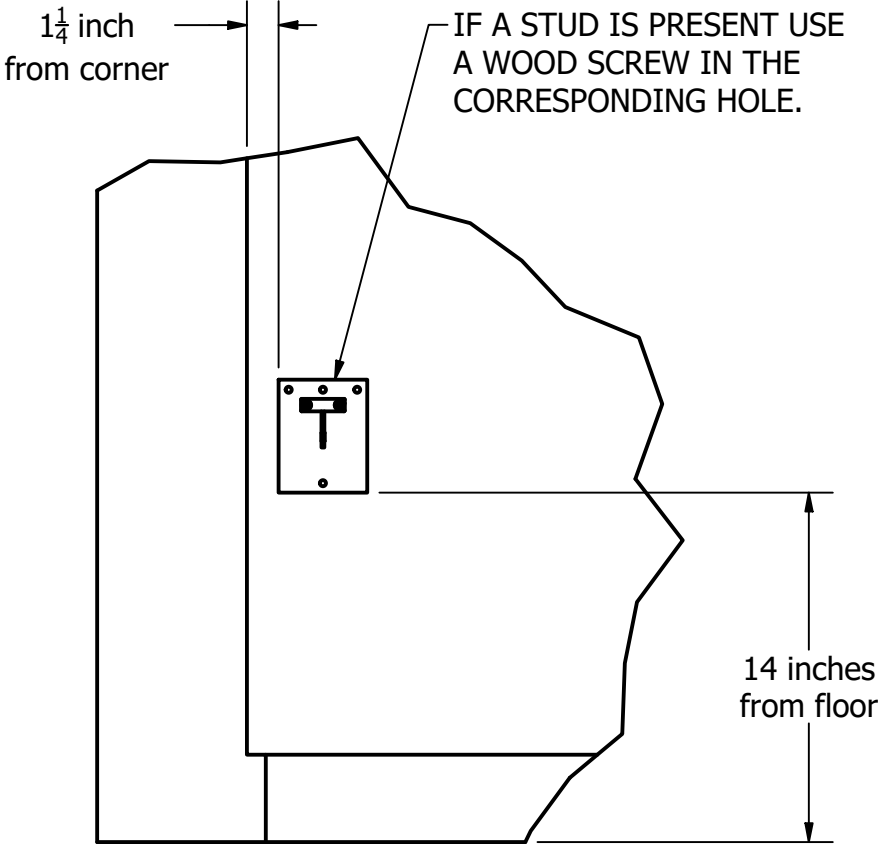

Locate where you would like to hang the ADJUST shelving.

- 1) Install lower bracket
- 2) Secure rail to lower bracket & level.
- 3) Mark & install upper bracket

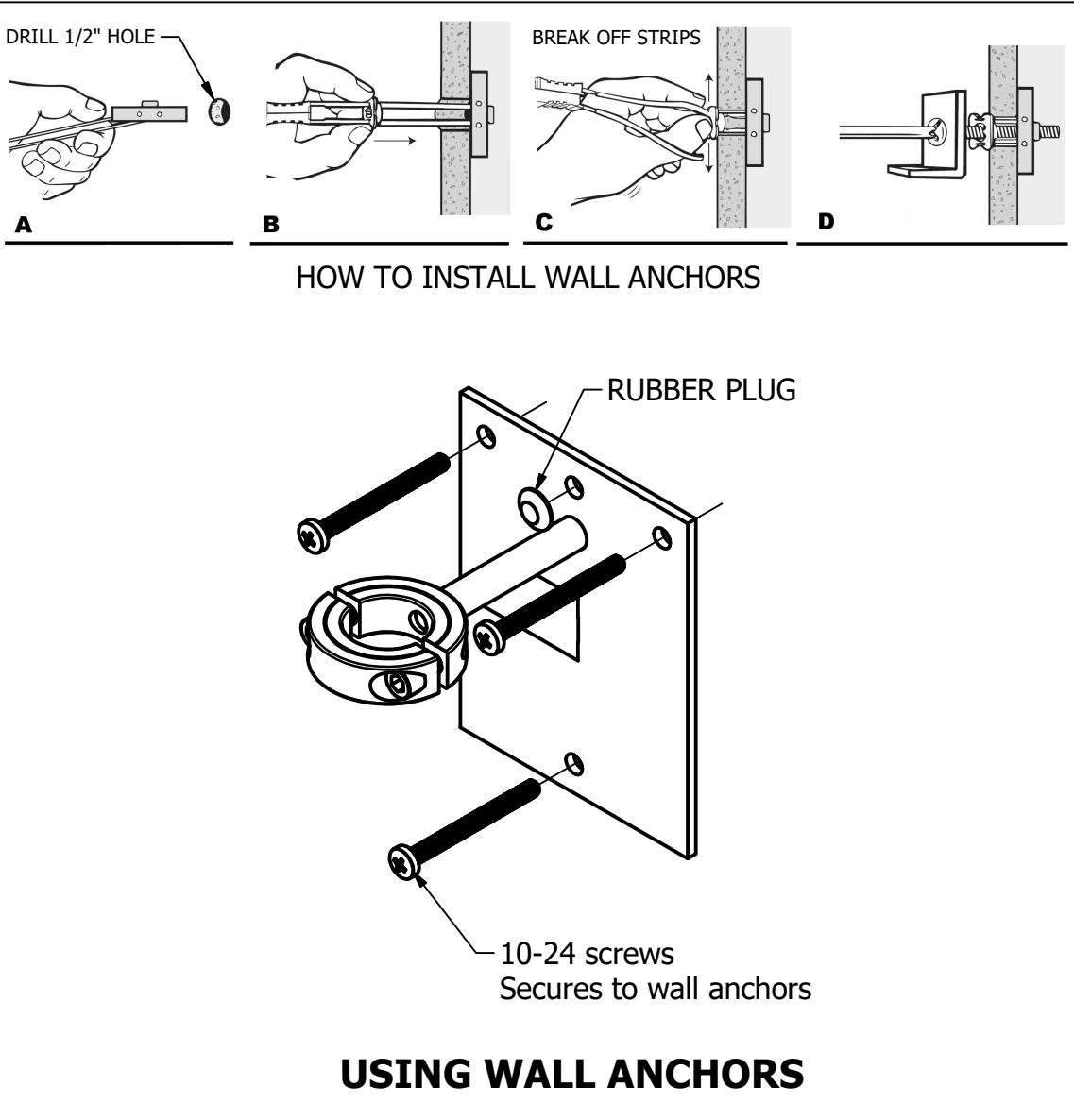
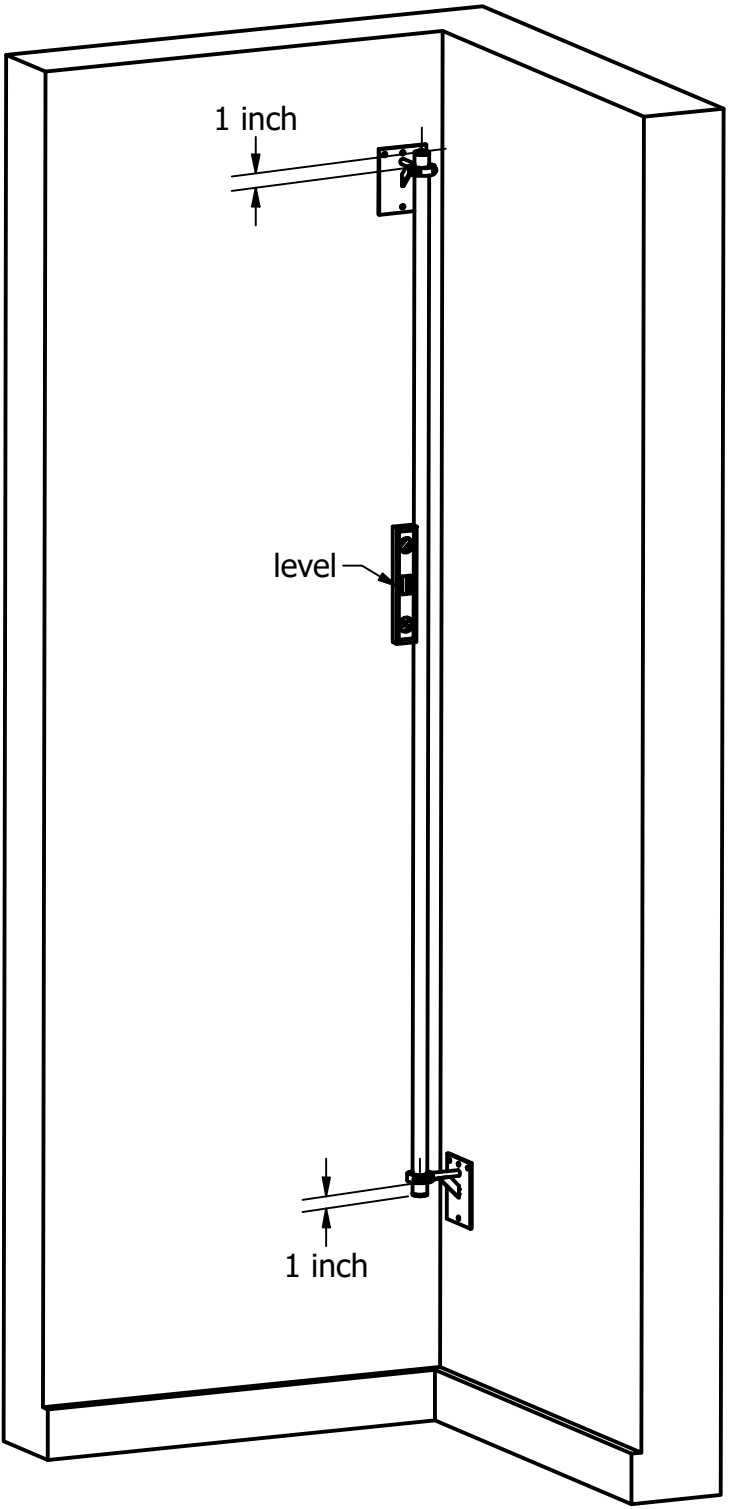

Add and Remove Shelves

